

VO Series

(10yr Design Life in Float Service at 20°C)

Dimensions (mm)

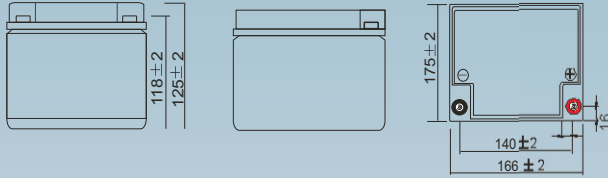

Standard terminal (mm)

T12 Terminal

Threaded insert 5mm Stud

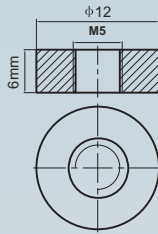

Torque: 2.0 - 3.0 Nm

Physical Specification

Nominal Voltage		12V
Nominal Capacity		26.0AH
Dimension	Length	166 ± 2 mm
	Width	175 ± 2 mm
	Container Height	118 ± 2 mm
	Total Height (with terminal)	125 ± 2 mm
Weight		Approx 7.8kg
Standard Terminal		T12

PS-12260V0 12V 26AH



Discharge Characteristics (25°C, 77°F)

Rated Capacity	20hr Rate(1.80V/cell)	26.0AH	Constant Voltage Charge	Cycle	Initial Charging Current Less than 6.5A Voltage 14.40V ~ 15.0V at 25°C (77°F)
	10hr Rate(1.80V/cell)	24.0AH			
Capacity Affected by Temperature	5hr Rate(1.75V/cell)	20.8AH	Standby	Recommended Charge Current less than 6.5A Voltage 13.5V ~ 13.8V at 25°C (77°F)	
	3hr Rate(1.75V/cell)	19.0AH			
	1hr Rate(1.60V/cell)	14.8AH			
	40°C (104°F)	103%			
	25°C (77°F)	100%			
	0°C (32°F)	86%			

Internal Resistance mΩ

14.0 mΩ

Constant Current Discharge (Amperes) at 25°C (77°F)

F.V/Time	10min	15min	20min	30min	45min	1h	2h	3h	4h	5h	6h	8h	10h	20h
1.85V/cell	31.0	25.8	22.0	18.0	13.6	11.4	7.28	5.77	4.67	3.78	3.31	2.65	2.27	1.26
1.80V/cell	39.6	31.2	26.0	21.2	15.8	12.8	7.94	6.21	4.99	4.06	3.56	2.82	2.40	1.27
1.75V/cell	43.5	34.1	28.0	22.0	16.4	13.4	8.24	6.32	5.11	4.16	3.65	2.86	2.42	1.28
1.70V/cell	47.4	36.4	29.4	22.9	17.1	13.8	8.57	6.50	5.24	4.27	3.73	2.90	2.45	1.31
1.65V/cell	51.1	38.7	31.3	24.2	17.5	14.3	8.81	6.77	5.42	4.39	3.81	2.95	2.50	1.32
1.60V/cell	55.5	41.4	33.3	25.5	18.2	14.8	9.10	6.98	5.59	4.53	3.89	2.98	2.52	1.33

Constant Power Discharge (Watts/cell) at 25°C (77°F)

F.V/Time	10min	15min	20min	30min	45min	1h	2h	3h	4h	5h	6h	8h	10h	20h
1.85V/cell	58.3	49.1	42.3	34.9	26.6	22.4	14.4	11.4	9.30	7.54	6.63	5.33	4.56	2.54
1.80V/cell	73.6	58.5	49.3	40.6	30.7	25.0	15.6	12.2	9.88	8.06	7.09	5.64	4.83	2.56
1.75V/cell	79.6	63.2	52.5	41.8	31.6	26.0	16.1	12.4	10.1	8.24	7.26	5.72	4.87	2.58
1.70V/cell	84.8	66.5	54.8	43.2	32.7	26.7	16.7	12.7	10.3	8.43	7.40	5.80	4.91	2.63
1.65V/cell	90.7	70.2	57.7	45.3	33.3	27.4	17.1	13.2	10.6	8.64	7.54	5.88	5.01	2.66
1.60V/cell	96.3	73.9	60.8	47.5	34.5	28.3	17.6	13.6	10.9	8.90	7.68	5.92	5.05	2.67

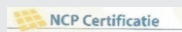
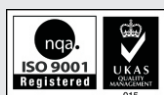

Power-Sonic Europe Limited
 3 Buckingham Square, Wickford, Essex, SS11 8YQ
 Tel: +44 (0)1268 560686 Fax: +44 (0)1268 560902
 sales@power-sonic.co.uk
 www.power-sonic.co.uk