

PS Range

(5yr Design Life in Float Service at 20°C)

Dimensions (mm)

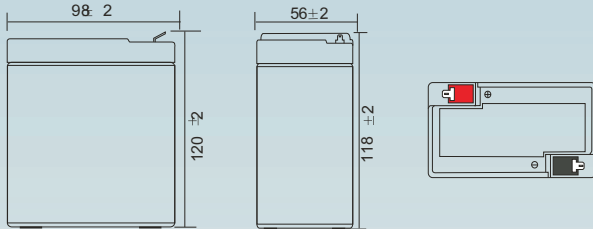

Standard terminal (mm)

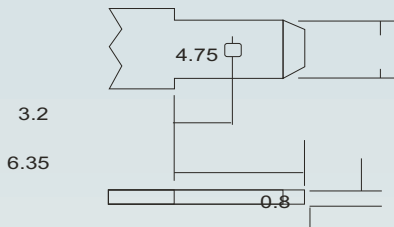

Physical Specification

Nominal Voltage		6V
Nominal Capacity (20HR)		8.0 AH
Dimension	Length	98 ± 2 mm
	Width	56 ± 2 mm
	Container Height	118 ± 2 mm
	Total Height (with terminal)	120 ± 2 mm
Weight		Approx 1.52kg
Standard Terminal		F1
Case and Cover Material		ABS (UL94-HB)

PS-682 6V 8.0AH



Operating Temperature Range

Storage (In fully charged condition)	- 20°C to + 60°C
Charge	- 15°C to + 50°C
Discharge	- 20°C to + 60°C

Discharge Characteristics (25°C, 77°F)

Rated Capacity	20hRate(1.80V/cell)			Cycle	Initial Charging Current Less than 2.0A Voltage 7.20V ~ 7.50V at 25°C (77°F)
	10hRate(1.80V/cell)	5hRate(1.75V/cell)	3hRate(1.75V/cell)		
8.50AH	7.91AH	7.25AH	6.51AH	Constant Voltage Charge	Recommended Charge Current less than 2.0A Voltage 6.75V ~ 6.90V at 25°C (77°F)
7.91AH	7.25AH	6.51AH	Standby		
7.25AH	6.51AH	5.34AH			
Capacity Affected by Temperature	40°C (104°F)	103%	100%	Standby	Recommended Charge Current less than 2.0A Voltage 6.75V ~ 6.90V at 25°C (77°F)
	25°C (77°F)	100%			
	0°C (32°F)	86%			

Internal Resistance mΩ

14.5mΩ

Constant Current Discharge (Amperes) at 25 °C (77°F)

F.V/Time	5min	10min	15min	20min	30min	45min	1h	2h	3h	4h	5h	6h	8h	10h	20h
1.85V/cell	16.2	12.4	10.3	8.90	6.88	5.07	4.27	2.53	1.98	1.61	1.31	1.14	0.918	0.767	0.421
1.80V/cell	21.7	15.9	12.4	10.5	8.12	5.90	4.79	2.76	2.13	1.72	1.41	1.22	0.973	0.791	0.425
1.75V/cell	24.5	17.5	13.6	11.3	8.43	6.12	5.01	2.86	2.17	1.76	1.45	1.25	0.990	0.812	0.429
1.70V/cell	27.0	19.0	14.5	11.9	8.78	6.36	5.17	2.93	2.23	1.80	1.48	1.28	1.004	0.828	0.437
1.65V/cell	29.7	20.5	15.4	12.6	9.26	6.52	5.29	2.98	2.32	1.86	1.52	1.31	1.020	0.845	0.443
1.60V/cell	32.8	22.3	16.5	13.5	9.78	6.80	5.34	3.10	2.39	1.92	1.57	1.34	1.030	0.854	0.445

Constant Power Discharge (Watts/cell) at 25°C (77°F)

F.V/Time	5min	10min	15min	20min	30min	45min	1h	2h	3h	4h	5h	6h	8h	10h	20h
1.85V/cell	29.6	23.0	19.2	16.8	13.1	9.75	8.25	4.91	3.86	3.14	2.57	2.24	1.81	1.52	0.834
1.80V/cell	39.3	29.0	22.9	19.5	15.2	11.2	9.19	5.32	4.13	3.34	2.75	2.39	1.92	1.56	0.841
1.75V/cell	43.4	31.3	24.7	20.8	15.7	11.6	9.57	5.50	4.18	3.40	2.81	2.45	1.94	1.60	0.848
1.70V/cell	46.4	33.4	26.0	21.7	16.2	12.0	9.84	5.62	4.29	3.49	2.88	2.49	1.97	1.63	0.863
1.65V/cell	50.5	35.7	27.4	22.9	17.0	12.2	9.99	5.67	4.46	3.59	2.95	2.54	2.00	1.66	0.873
1.60V/cell	54.4	37.9	28.9	24.1	17.8	12.6	10.0	5.89	4.57	3.69	3.03	2.59	2.01	1.68	0.877



Power-Sonic Europe Limited
 3 Buckingham Square, Wickford, Essex, SS11 8YQ
 Tel: +44 (0)1268 560686 Fax: +44 (0)1268 560902
 sales@power-sonic.co.uk
 www.power-sonic.co.uk